

CAT5E KVM SWITCHES

Single User Cat5E KVM Switch (IP Optional)

MODEL CODE TYPE

- NEW** AKS-008 1 user/8 Port
- NEW** AKS-016 1 user/16 Port
- NEW** AKS-032 1 user/32 Port

OPTIONAL

- NEW** AKS-01P PS/2 Cat5e dongle
- NEW** AKS-01U USB Cat5e dongle
- NEW** AKIP-90 IP Module
- NEW** AKS-150S Remote Console 150 meter
- NEW** AKS-300S Remote Console 300 meter

FEATURES

- Supports both of USB and PS/2 server
- Three models available: 8-port (AKS-008), 16-port (AKS-016) and 32-port (AKS-032)
- Can be cascaded up to 2 levels to control more servers
- Each server can be up to 50 meters apart using CAT5 UTP cable with either USB dongle (AKS-01U) or PS/2 dongle (AKS-01P)
- Both dongles support the auto screen adjustment
- Easy switching via hotkey w/OSD, front touch pad w/LED and IR remote control
- Add a server at any time without interrupting other servers operation
- Both of USB and PS/2 keyboard/mouse are available for the console management
- Firmware upgradable via USB port
- Supports both of local console management and remote console (an optional module is required) management
- Optional: 2 remote console modules are available: 150 meters (AKS-150S) and 300 meters (AKS-300S) (When remote console in use, local console ports inactive)
- Optional: IP module (AKIP-90) can be added to the unit, allowing the user to manage the servers from anywhere all around the world via TCP/IP internet

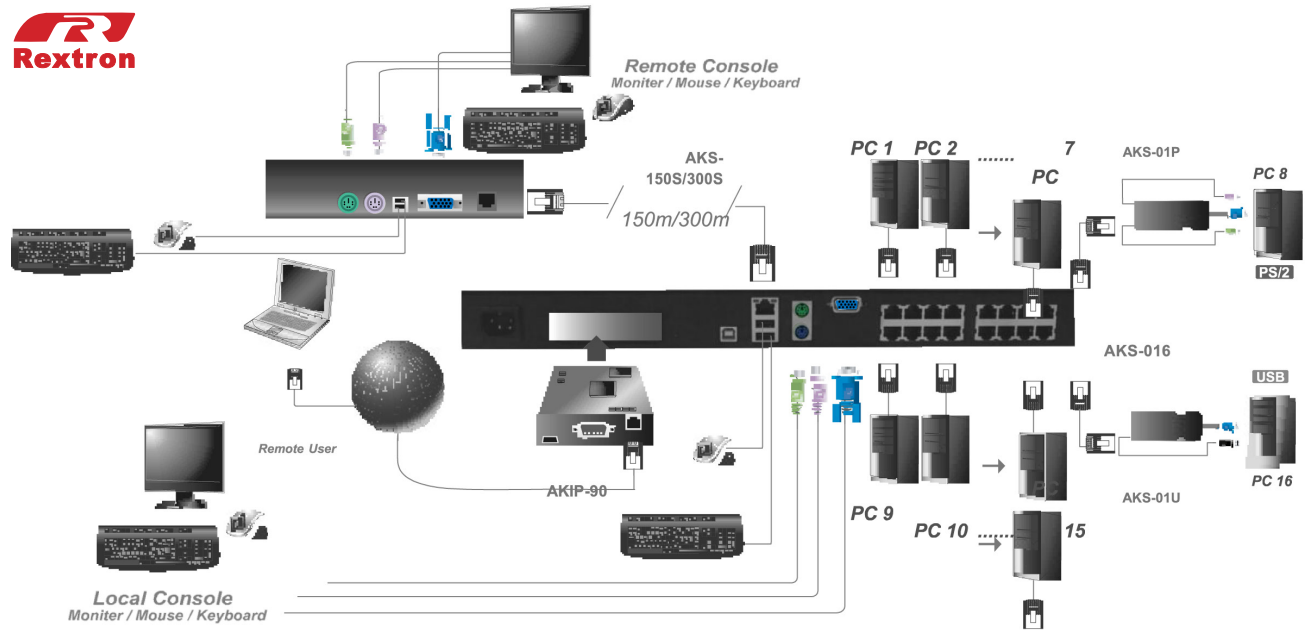

Model Code		AKS-008	AKS-016	AKS-032
Local Console	Monitor: HDD15F	1	1	1
	PS/2 Keyboard: MiniDin6F	1	1	1
	PS/2 Mouse: MiniDin6F	1	1	1
	USB Keyboard: Type A Male	1	1	1
	USB Mouse: Type A Male	1	1	1
F/W Upgrade	USB upgrade: Type B Female	1	1	1
CPU Connector	System In: RJ45	8	16	32
Remote Console	Extension Link: RJ45	1	1	1
Control	Hotkey w/OSD, Touch Pad with LED and Remote Control		Distance	Up To 300 m (1000 ft)
Video	1600x1200@60Hz Up To 300m (1000feet) (subject to cable and VGA signal quality)		System Cable	CAT5e, RJ-45 connector
Power	AC100~240V		Operating Temp.	0°~60°C (32°~140°F)
Storage Temp.	-40°~70°C (-40°~158°F)		Dimensions	440x185x42mm
Weight		2500g	3700g	5500g